

# CAL. 28-10

## Taylor Terrace - San Joaquin

28 Units (155 - 182)  
 Constructed 1953  
 14 bldgs. w/2 units/bldg.

Unit # is identifier  
 Sidewalks - 2,430 Sq. Ft.  
 Parking Area - 5,388 Sq. Ft.

UNIT	ADDRESS	UNIT	ADDRESS
155	8410 Fifth Street (2)	169	8417 Sixth Street (3)
156	22199 Nevada Ave. (2)	170	8419 Sixth Street (3)
157	8412 Fifth Street (3)	171	8427 Sixth Street (3)
158	8414 Fifth Street (3)	172	8425 Sixth Street (3)
159	8420 Fifth Street (2)	173	8429 Sixth Street (1)
160	8422 Fifth Street (2)	174	8431 Sixth Street (4)
161	8432 Fifth Street (2)	175	8433 Sixth Street (2)
162	8434 Fifth Street (2)	176	8435 Sixth Street (2)
163	8430 Fifth Street (1)	177	8421 Sixth Street (2)
164	8428 Fifth Street (4)	178	8423 Sixth Street (2)
165	8424 Fifth Street (3)	179	8415 Sixth Street (3)
166	8426 Fifth Street (3)	180	8413 Sixth Street (3)
167	8418 Fifth Street (3)	181	22169 Nevada Ave. (2)
168	8416 Fifth Street (3)	182	8411 Sixth Street (2)

1 Bdrm. -2	2 Bdrm. -12	3 Bdrm. -12	4 Bdrm. -2	5 Bdrm. -0
------------	-------------	-------------	------------	------------

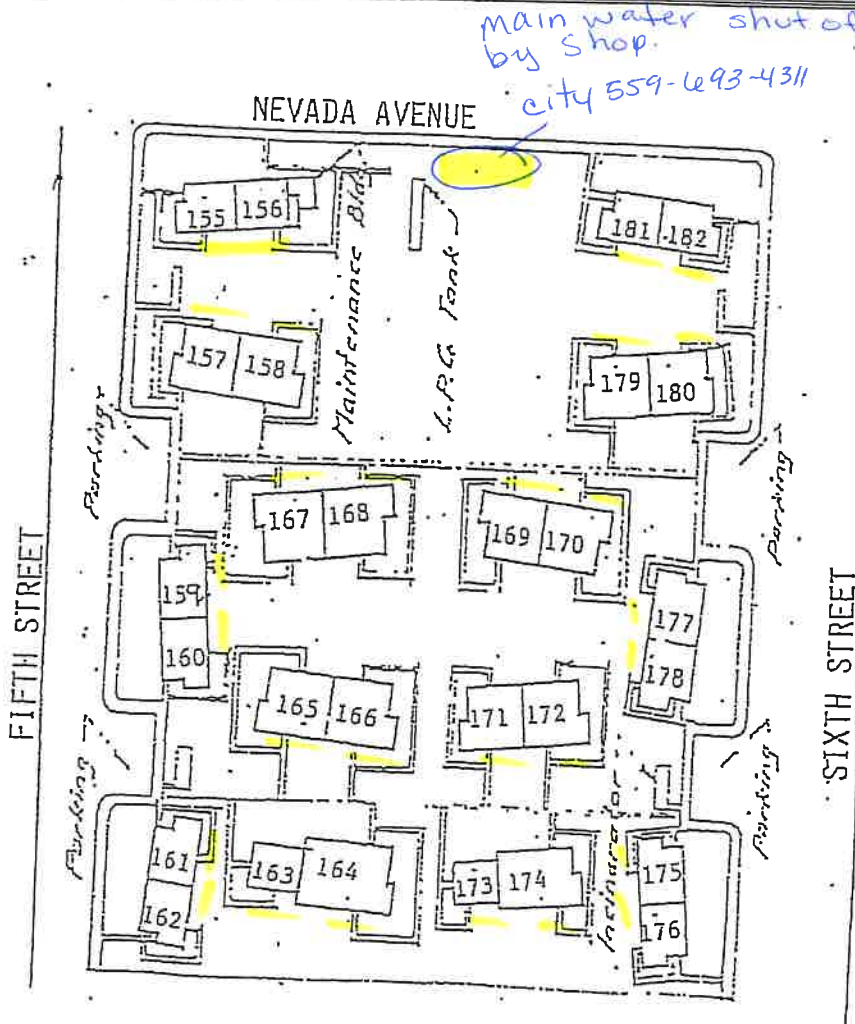

clean outs  
 Back of unit

Unit water shut  
 off valve  
 Back of unit  
 near Back Door

electrical subpanel  
 Back of unit